

Supreme Air Venturi

Laboratory Fume Hoods

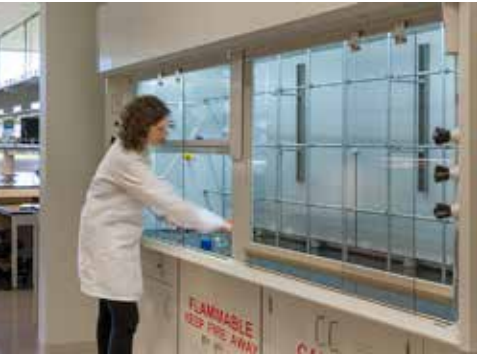

KEWAUNEE[®]

encouraging new discovery... *Worldwide*

VENTURI

The most technologically advanced fume hood on the market

The Next Generation Fume Hood

- Unparalleled Venturi enhanced containment technology
- Electromechanical sash stop
- LED lights with color and intensity adjustability
- Unique ultra-smooth sash system
- Exceptional viewing height
- Flush airfoil
- High performance/energy efficient
- Multiple heights, depths and widths
- Full range of accessories and options
- ADA hood height matches adjacent hoods

The Supreme Air Venturi utilizes proven containment enhancing techniques coupled with innovative laboratory convenience features.

- Adjustable LED lights
- Electromechanical sash stop
- Ultra-smooth sash system
- Push-button sash management

The Supreme Air Venturi provides the safest user friendly fume hood manufactured today.

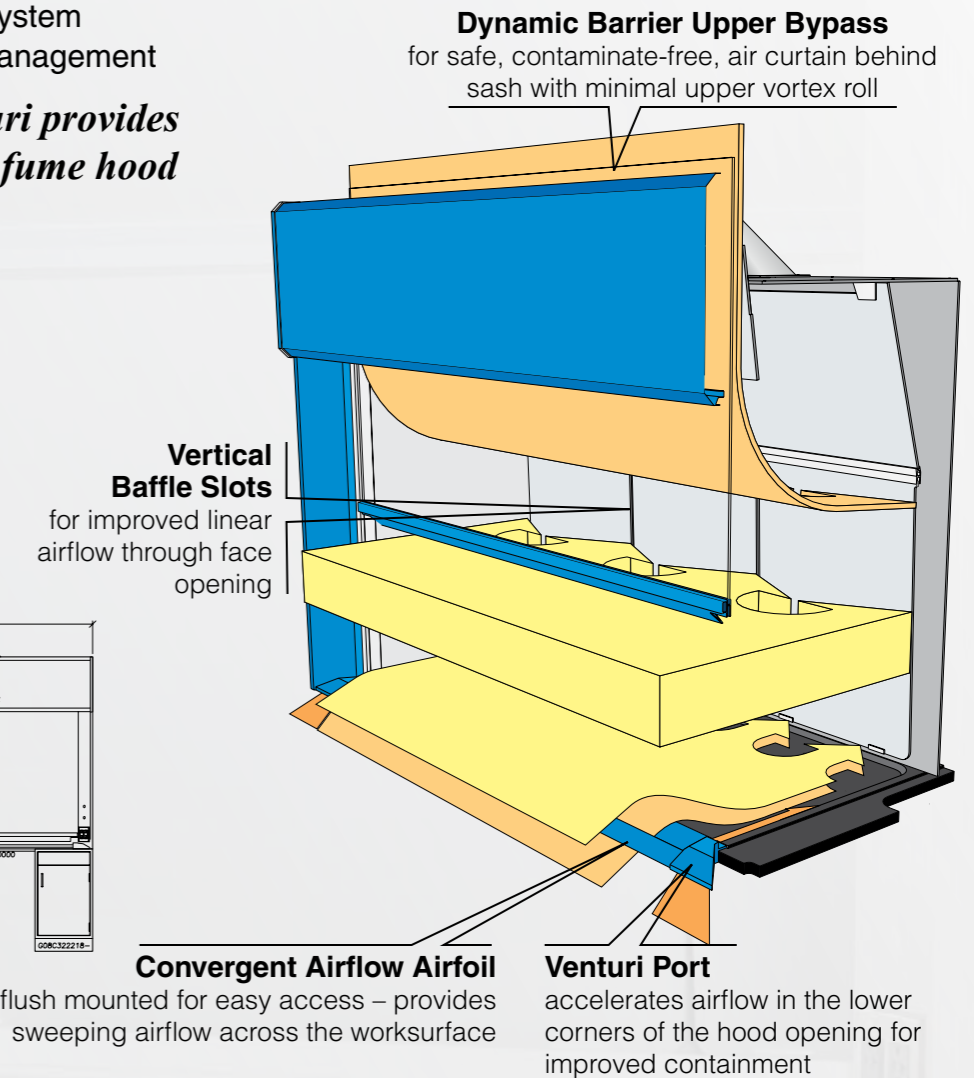
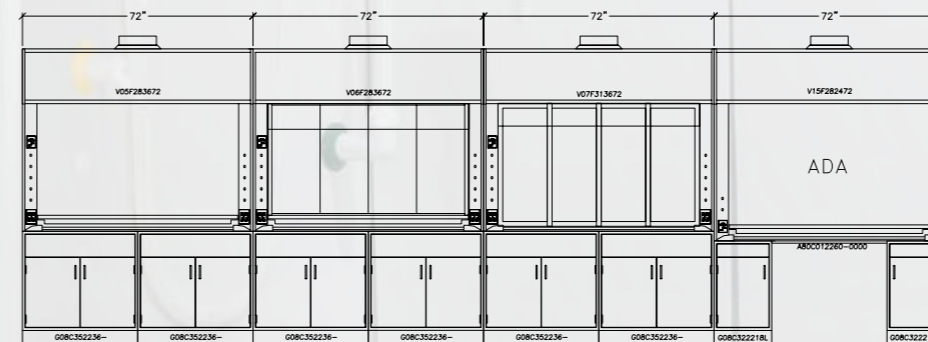

Venturi Effect

"A short tube with tapering constriction in the middle that causes an increase in velocity of flow...or creating suction." *Oxford Dictionary*

Giovanni Batista Venturi – (1746-1822)

The Venturi Port accelerates the airflow in the lower corners of the hood opening. *patent pending*



Combination Sash Bench Hood



Vertical Rising Sash Bench Hood

Venturi Fume Hood Features



Light & Sash Stop Controller

Belt Driven Sash & Pulley System

- No maintenance, dual shaft, belt and gear driven, sash system utilizing lineal bearings in the sash track for smooth operation



- Tested to 300,000 cycles

General Features

- Unparalleled containment
- Low flow/high performance
- Energy efficient
- Venturi post design improves corner airflow
- 38¹/₂" viewing height
- LED interior lighting with 15 intensity and 3 color settings
- Electromechanical sash stop integrated into sash track
- Flush airfoil for easy access
- Easily removable gasketed access panels
- Two GFCI protected duplex receptacles in each corner post
- Room for five service fittings per side post
- Sash handle notched at each end for cord pass-through



Venturi Port & Notched Sash Handle



Venturi Fume Hood Types

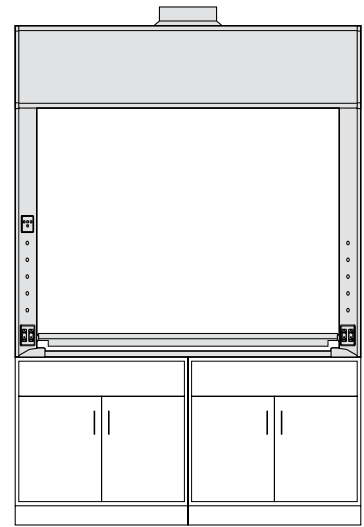
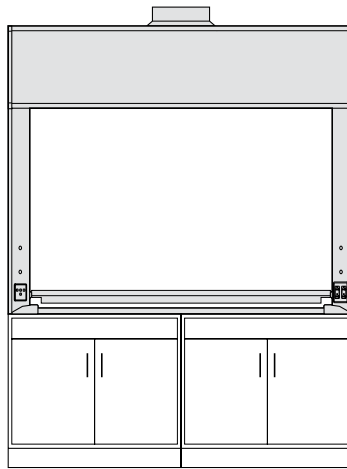
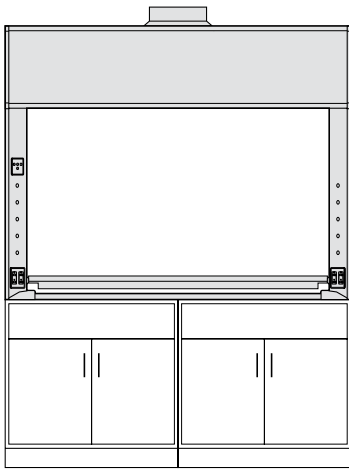

General Purpose Bench Hood

ADA Bench Hood

LX Series Bench Hood

	Sash Configurations	Sash Configurations	Sash Configurations
Vertical Sash	•	•	•
Combination Sash	•	•	•
Horizontal Sash	•		
	Liner Options	Liner Options	Liner Options
KMER	•	•	•
Kemglass	•	•	•
Phenolic Resin	•	•	•
Type 304L Stainless Steel	•	•	•
Type 316L Stainless Steel	•	•	•
Sash Opening Heights	28"	28"	28" - 35"
Inside Depths	24" - 30" - 36"	24"	24" - 30" - 36"
Overall Lengths	48" - 60" - 72" - 96"	48" - 60" - 72"	48" - 60" - 72" - 96"

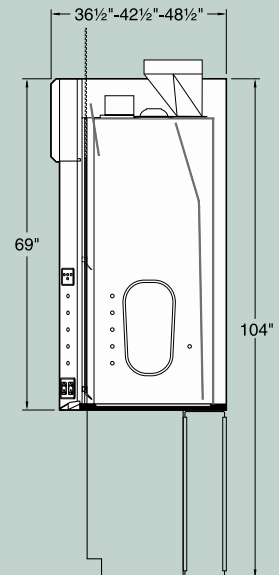
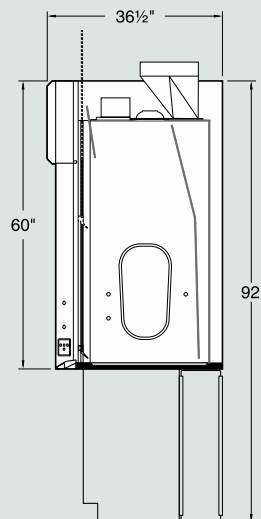
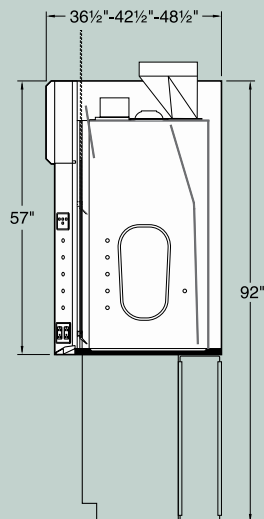

Kewaunee Venturi Fume Hood Types and Options

Venturi Fume Hood Types	
V05	General Purpose Bench Fume Hood with 28" Frameless Vertical Rising Sash Depth: 24"-30"-36" Length: 48"-60"-72"-96"
V06	Combination Sash Bench Fume Hood with 28" Combination Vertical Rising/Horizontal Sash Depth: 24"-30"-36" Length: 48"-60"-72"-96"
V07	Horizontal Sash Bench Fume Hood with 31" Frameless Four Panel Horizontal Sash Depth: 24"-30"-36" Length: 48"-60"-72"-96"
V15	ADA Bench Fume Hood with 28" Frameless Vertical Rising Sash Depth: 24" Length: 48"-60"-72"
V16	ADA Bench Fume Hood with 28" Combination Vertical/Horizontal Sash Depth: 24" Length: 48"-60"-72"
V25	LX Series Bench Fume Hood with 28" & 35" Frameless Vertical Rising Sash Depth: 24"-30"-36" Length: 48"-60"-72"-96"
V26	LX Series Bench Fume Hood with 28" & 35" Combination Vertical/Horizontal Sash Depth: 24"-30"-36" Length: 48"-60"-72"-96"

Standard Options

- KMER Liner
- Kemglass Liner
- Stainless Steel Liner
- Phenolic Resin Liner
- Laminated Safety Glass Sash
- Tempered Safety Glass Sash
- Rod Controlled Needle Valve Fittings
- Rod Controlled Ball Valve Fittings
- Front Load Needle Valve Fittings
- Variable Air Volume (VAV) By-pass
- Air Alert 600 Alarm
- Air Alert 300 Alarm
- Sash Stop Label
- Distillation Rack
- Safety Shield
- Tissue Screen
- Specification Grade GFCI Receptacles
- Hospital Grade GFCI Receptacles
- Fan/Blower Switch
- Pre-wired
- Pre-plumbed
- Stainless Steel Airfoil
- Stainless Steel Sash Pulls
- Stainless Steel Duct Collar
- Cord Port
- Auto Sash Return
- Auto Sash Operator



Kewaunee Scientific Corporation is dedicated to manufacturing high quality products for the laboratory marketplace. We offer Total Laboratory Solutions, Innovative Designs, and Technological Expertise with a worldwide distribution network to provide laboratories that are truly World Class!

For our complete product offering, specifications, catalogs, brochures, case studies, and distributor list, go to www.kewaunee.com, or contact your local sales representative.



Kewaunee, Alpha, Basic Bench, EarthLine, Enterprise, Evolution, Interceptor, Kemresin, Kewaunee Matrix, Research Collection, Signature, Sturdilite, and Supreme Air are registered trademarks of Kewaunee Scientific Corporation



P.O. Box 1842 • Statesville, NC 28687-1842
Phone: (704) 873-7202 • Fax: (704) 873-5160
E-mail: kscmarketing@kewaunee.com
Web Site: www.kewaunee.com

Kewaunee Labway India Pvt. Ltd.
No. CA-9A, 2nd Floor, Jigani Link Road
Jigani, Bangalore 562 106, India
Phone: 9180-27826725 • Fax: 9180-27826724
Web Site: www.kewaunee.in

Kewaunee Labway Asia Pte. Ltd.
194 Pandan Loop, #06-22
Pantech Business Hub, Singapore 128 383
Phone: 65-6773-0288 • Fax: 65-6773-2322

Kewaunee Scientific (Suzhou) Co Ltd
333 Xingpu Road, Modern Industrial Square
Building 4, Unit #2-A • Suzhou Industrial Park • China
Phone: (0512) 6262 5090 • Fax: (0512) 6262 5089
Web Site: china.kewaunee.com